

PROTECTA Series

CONTROL DEVICE



REFERENCE STANDARDS

EN 60669-1
Switches for household and similar fixed-electrical installation.
Part 1: general requirements.

VERSIONS

	One way switch single pole - flush mounting - surface mounting
	Two way switch single pole - flush mounting - surface mounting
	Intermediate switch - flush mounting - surface mounting
	Bell push switch single pole - flush mounting - surface mounting
	Double pole switch - flush mounting - surface mounting

TECHNICAL CHARACTERISTICS

Rated current:	10A-10AX-20A-20AX
Rated voltage:	250V~
Frequency:	50Hz
Insulating voltage:	250V~
Protection degree:	IP66
Operating ambient temperature:	-20°C +60°C
Cabling capacity of the terminal:	3x2,5mm² 2x4mm² 1x6mm²
Glow Wire test:	650°C/850°C
Halogen free:	Yes
Material:	Engineering plastic
Cable inlet:	M20
Colour:	Grey RAL 7035
LED colour:	Orange

BEHAVIOUR WITH CHEMICAL AND ATMOSPHERIC AGENTS

Saline solution	Acids		Bases		Solvents				Mineral oil	UV rays
	Concentrated	Diluted	Concentrated	Diluted	Hexane	Benzol	Acetone	Alcohol		
Resistant	Limited Resistance	Resistant	Limited Resistance	Resistant	Resistant	Not Resistant	Not Resistant	Resistant	Limited Resistance	Resistant

UNSWITCH SOCKET OUTLETS



REFERENCE STANDARDS

CEI 23-50
Plugs and sockets for domestic and similar applications.
Part 1: general requirements.

IEC 60884-1
Plugs and socket-outlets for household and similar purposes.
Part 1: general requirements.

TECHNICAL CHARACTERISTICS

Rated current:	10A-13A-15A-16A
Rated voltage:	250V~
Frequency:	50Hz
Insulating voltage:	250V~
Protection degree:	IP66
Operating ambient temperature:	-5°C +60°C
Installation ambient temperature:	-20°C +60°C
Cabling capacity of the terminal:	10A: 0,75 mmq - 2,5 mmq 13A: 2,5 mmq - 6 mmq 15A: 2,5 mmq - 6 mmq 16A: 1 mmq - 2,5 mmq (according to ref. standard)
Glow Wire test:	650°C / 850°C
Halogen Free:	Yes
Material:	Engineering plastic
Cable inlets:	M20
Colour:	Base: Grey RAL 7035 Cover: tinted transparent

The IP66 degree of protection with the plug inserted is guaranteed mainly with angled plugs which can be coupled with the respective Standard sockets. This is the breakdown for the main Italian and European standards (Europe mainland):	Italian bivalent standard 16A P17/P11	Italian standard – 16A P30	German standard 16A	French standard – 16A P31
	Plug 10A 2P+E extra flat SPA11	Wireable (body length up to 50 mm)	•	
Permanent (body length up to 50 mm)		•		
Plug 16A 2P+E extra flat SPA17	Wireable (body length up to 50 mm)	•		
	Permanent (body length up to 50 mm)	•		
Plug 10A 2P straight S10 "Europlug"	Wireable (body length up to 41 mm)		•	•
	Permanent (body length up to 50 mm)		•	•
Plug 10A 2P+E straight S11	Wireable (body length up to 41 mm)		•	
	Permanent (body length up to 50 mm)		•	
Plug 16A 2P+E straight S30	Wireable (body length up to 41 mm)		•	
	Permanent (body length up to 45 mm)		•	
Plug 16A angled S30	Wireable (body length up to 60 mm)		•	
	Permanent (body length up to 65 mm)		•	
Plug 16A angled S31	Wireable (body length up to 60 mm)		•	•
	Permanent (body length up to 65 mm)		•	•

ENCLOSURES



VERSIONS

	Empty 1-module enclosure - flush mounting - surface mounting
	Empty 2-module enclosure - flush mounting - surface mounting
	Pole side by side enclosure
	Pole-top enclosure
	3-module flush-mounting box adapter IP55

REFERENCE STANDARDS

EN 60670-1 (2005-10)
Boxes and enclosures for electrical accessories for household and similar fixed electrical installations.
Part 1: general requirements.

TECHNICAL CHARACTERISTICS

Protection degree:	IP66 (*)
Operating ambient temperature:	-5°C +60°C
Installation ambient temperature:	-20°C +60°C
Glow Wire test:	650°C
Halogen free:	Si
Material:	Engineering plastic
IK degree at 20°C:	IK07
Cable inlets:	M20
Colour:	Base: grey RAL 7035 Cover: tinted transparent

(*) IP55 for 3-module flush-mounting box adapter flange.

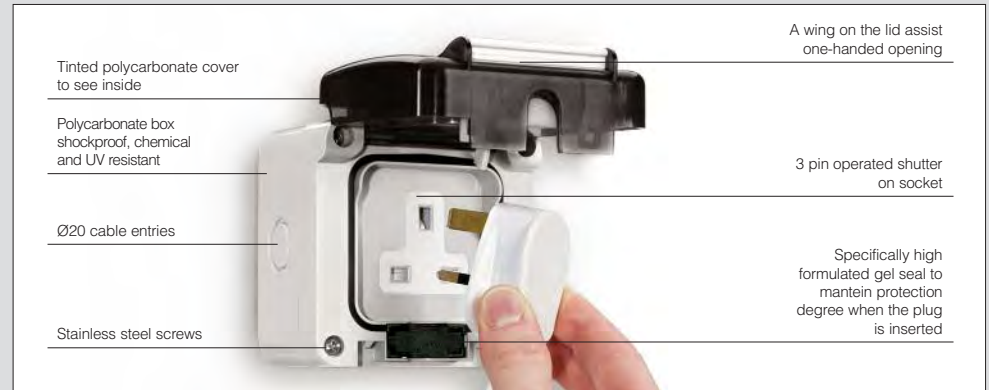

AVAILABLE STANDARDS

	ITALIAN STANDARD P17/11 - 16A Shuttered socket CEI 23-50		ITALIAN STANDARD P30 - 16A Shuttered socket CEI 23-50		GERMAN STANDARD - 16A Shuttered socket DIN VDE 0620		FRENCH STANDARD - 16A Shuttered socket NFC 61-314		BRITISH STANDARD - 13A Shuttered socket BS 1363-2 BS 7288:1990
	BRITISH STANDARD - 15A Shuttered socket BS 546		ARGENTINIAN STANDARD - 10A Unshuttered socket IRAM 2071		NEOZELANDER STANDARD - 10A Unshuttered socket AS/NZS 3112		SWISS STANDARD - 10A Unshuttered socket SEV 1011:1996		BRAZILIAN STANDARD - 10A Unshuttered socket ABNT NBR 14136:2002