



TO ALL OUR CUSTOMERS

NEW 1. DIN GUIDE FACING FOR 16A, 32A and 40A SWITCH-DISCONNECTORS

Scame has also introduced a new direct control with DIN guide facing for 16A, 32A and 40A switch-disconnectors.

DESCRIPTION	COLOUR	PACKING QUANTITY	CATALOGUE NUMBER
DIN guide facing		1/10	590.YMDIN

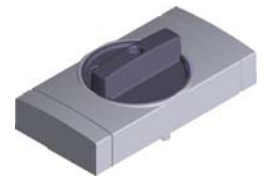



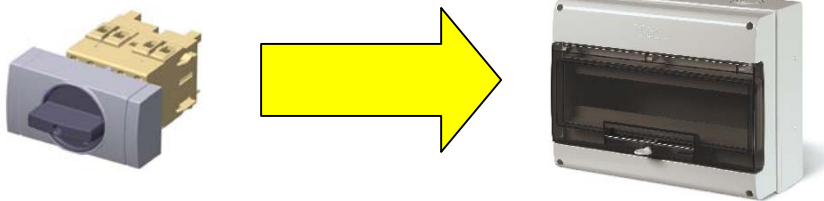





This new control with facing allows the switch-disconnector to be used on a DIN guide. The facing covers the DIN slot and thus avoids dangerous situations or the accidental introduction of foreign bodies inside the switchboard/electrical panel.



NEW 2. 70x87 FRONT CONTROLS FOR SWITCH-DISCONNECTORS

New front controls for switch-disconnectors have been introduced. These new controls are suitable for use with 16A, 32A, 40A, 63A, 80A switch-disconnectors.

70X87mm FRONT CONTROLS

DESCRIPTION	FOR SWITCHES	KNOB	FRONT PLATE	PACKING QUANTITY	CATALOGUE NUMBER
	16A, 32A and 40A			1/10	590.YM70R1
For R modules				1/10	590.YM70R2
	63A and 80A (*)			1/10	590.YM70R6
				1/10	590.YM70R7



(*) the 590.YM70R6 and 590.YM70R7 can be used only on the cutout with indents for fastening 32A flush mounting sockets

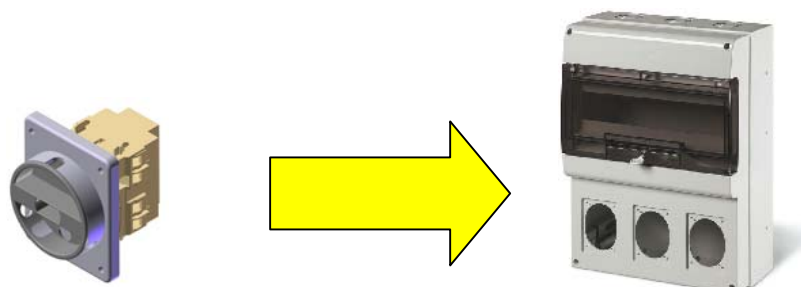



NEW 3. 22mm-DIAMETER FRONT CONTROLS FOR SWITCH-DISCONNECTORS

New front controls for switch-disconnectors have also been introduced which fasten onto the panel/switchboard by means of simple 22mm-diameter holes. The installation is quick and easy.

These new direct controls are suitable for use with 16A, 32A, 40A, 63A, 80A switch-disconnectors.

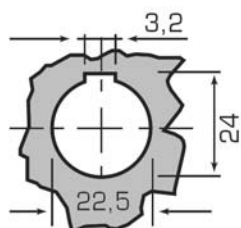

Drilling template (mm)

67X67mm FRONT CONTROLS

DESCRIPTION	FOR SWITCHES	KNOB	FRONT PLATE	PACKING QUANTITY	CATALOGUE NUMBER
for R modules	16A, 32A and 40A			1/10	590.YM68R1
				1/10	590.YM68R2
for B modules	16A, 32A and 40A			1/10	590.YM68B1
				1/10	590.YM68B2
for B modules	63A and 80A			1/10	590.YM68B6
				1/10	590.YM68B7

67



48X48mm FRONT CONTROLS

DESCRIPTION	FOR SWITCHES	KNOB	FRONT PLATE	PACKING QUANTITY	CATALOGUE NUMBER
for R modules	16A, 32A and 40A			1/10	590.YM50R1
				1/10	590.YM50R2
for B modules	16A, 32A and 40A			1/10	590.YM50B1
				1/10	590.YM50B2

48



LOCKABLE 48X48mm FRONT CONTROLS

DESCRIPTION	FOR SWITCHES	KNOB	FRONT PLATE	PACKING QUANTITY	CATALOGUE NUMBER
for R modules	16A, 32A and 40A			1/10	590.YM51R1
				1/10	590.YM51R2
for B modules	16A, 32A and 40A			1/10	590.YM51B1
				1/10	590.YM51B2

48







NEW 4. DIRECT CONTROLS FOR SWITCH-DISCONNECTORS

Scame has also introduced new direct controls for switch-disconnectors. These new direct controls are suitable for use with 16A, 32A, 40A, 63A, 80A switch-disconnectors.

DIRECT CONTROLS

DESCRIPTION	FOR SWITCHES	COLOUR	PACKING QUANTITY	CATALOGUE NUMBER
Per B and R modules	16A, 32A and 40A		1/10	590.YMC1
	63A and 80A		1/10	590.YMC2

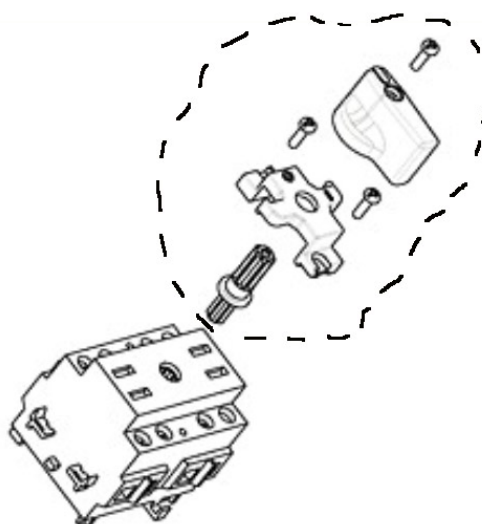

SCAME PARRE SPA
MARKETING OFFICE