

> DOMESTIC ADAPTORS

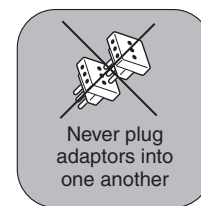

> REFERENCE STANDARDS

CEI 23-57
Plugs and sockets for domestic and similar applications
Part 2: specific requirements for adaptors



> VERSIONS

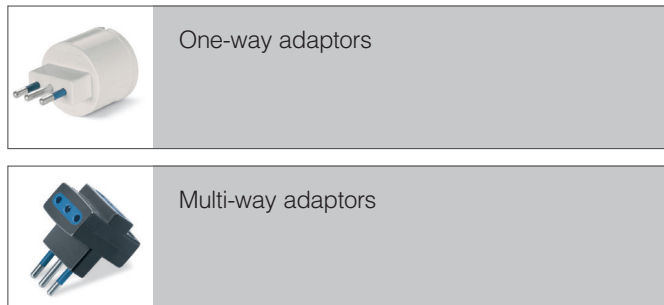

> QUALITY MARKS



> TECHNICAL CHARACTERISTICS

Rated current:	10A - 16A
Rated voltage:	250V~
Frequency:	50Hz
Insulating voltage:	250V~
Protection degree:	IP20D
Operating temperature according to the reference standard:	-15°C +35°C
Max operating temperature:	60°C
Glow wire test:	750°C
Halogen free:	Yes
Material:	Engineering plastic
Colour:	White RAL 9010 Black RAL 9011

> BEHAVIOUR WITH CHEMICAL AND ATMOSPHERIC AGENTS

Saline solution	Acids		Bases		Solvents				Mineral oil	UV rays
	Concentrated	Diluted	Concentrated	Diluted	Hexane	Benzol	Acetone	Alcohol		
Resistant	Limited Resistance	Resistant	Limited Resistance	Limited Resistance	Resistant	Not Resistant	Not Resistant	Resistant	Limited Resistance	Resistant

> APPLICATION EXAMPLES

