

> LAMPHOLDER



> REFERENCE STANDARDS

- EN 60238**
 Edison screw lampholders
- EN 60400**
 Lampholders for tubular fluorescent lamps and starterholders
- EN 60838-1**
 Miscellaneous lampholders
Part 1: general requirements and tests
- EN 61058-1**
 Switches for appliances
Part 1: general requirements

> VERSIONS

- Lampholders
 - For incandescent lamps (E14-E27)
 - For fluorescent lamps (G5-G23)
 - For halogen lamps (G4-GX53-GY6.35-R75)
- Switches
 - press switches
 - pull switches
 - slide in-line switches
 - foot switches
- Ceiling accessories

> QUALITY MARKS

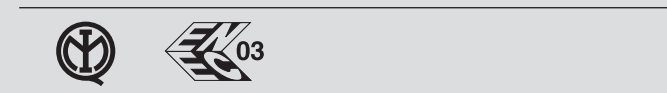

> TYPE OF COUPLING

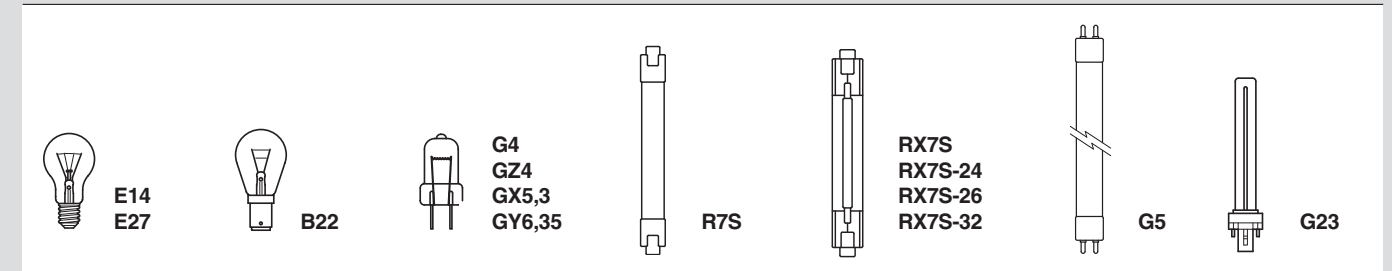

> APPLICATION EXAMPLES



Thermoset lampholders: left, with E27 coupling, partly threaded skirt and metal nipple; right, with E14 coupling, fully threaded skirt and moulded thread.



Metal lampholder. Detail of locking screw and earth terminal.



Slide in-line switch, with neutral connection for flat cable.

> DIMENSIONS

COD. 190.3750S - 190.35855

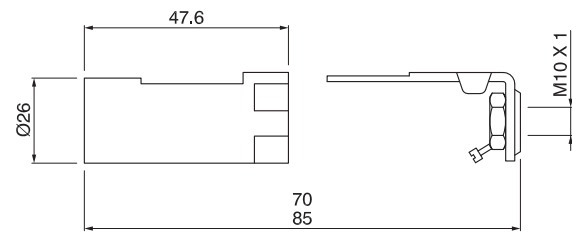

COD. 190.3750ES - 190.3585ES

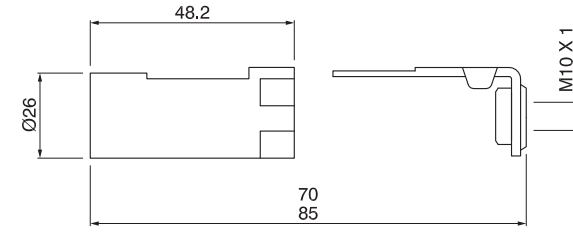

COD. 190.5740B1

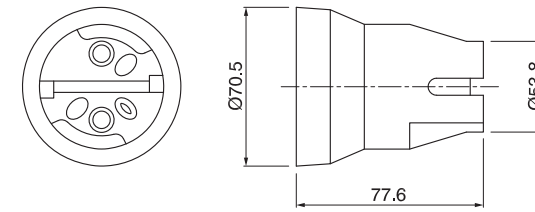

COD. 191.5123

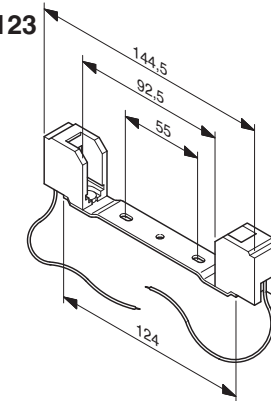

COD. 190.5778B

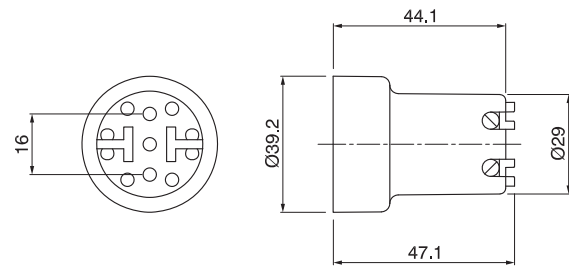

COD. 190.5778/304T

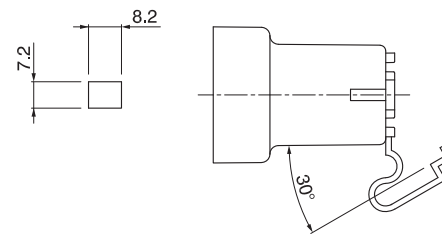

COD. 191.5122

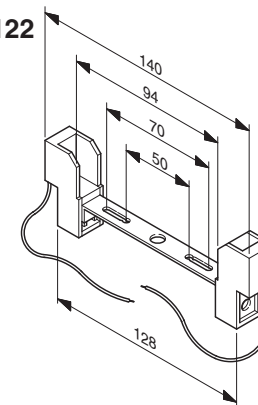

COD. 191.5124

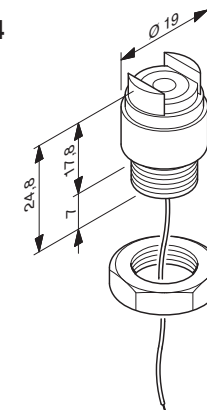

COD. 190.5778/306L

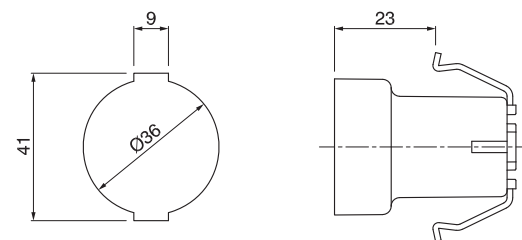

COD. 190.5778/311T

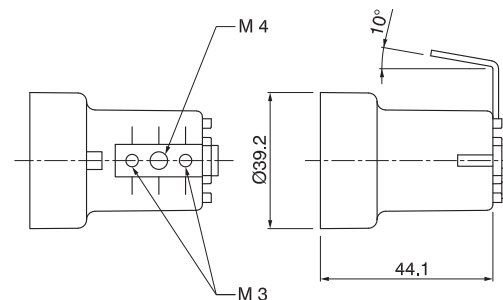

COD. 191.6001B

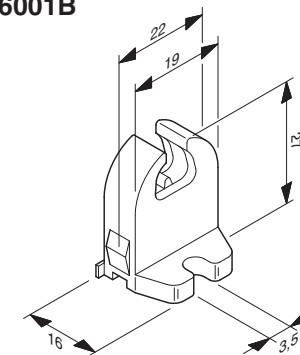

COD. 191.5010B

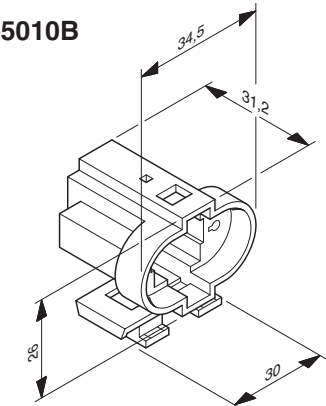

COD. 190.5778/348

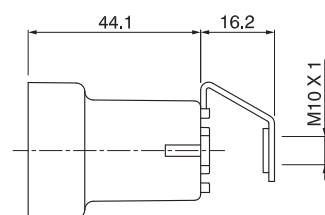

COD. 190.5727

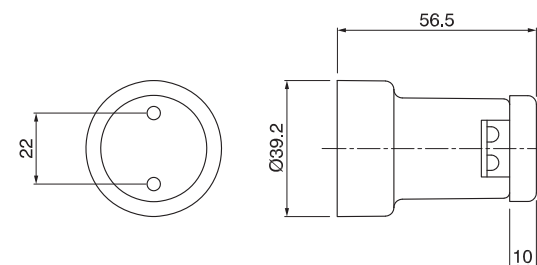

COD. 191.5031

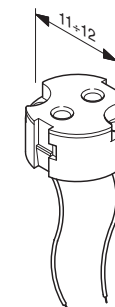

(Dimensions in mm)

(Dimensions in mm)